

ROADS (SCOTLAND) ACT 1984

THE CITY OF EDINBURGH COUNCIL (CALTON ROAD, GREENSIDE ROW, LEITH STREET AND, WATERLOO PLACE EDINBURGH) (REDETERMINATION OF MEANS OF EXERCISE OF PUBLIC RIGHT OF PASSAGE) ORDER 201 - RSO/17/13

Plan showing the length of road over which means of exercise of public right of passage is to be redetermined in terms of the above Order, which will come into operation on the Executed by The City of Edinburgh Council this day of 201

Executive Director of Place

(witness)





Plan 1 of 4

SERVICE YARD EXIT



EXTENT OF LEITH STREET WORKS CONTAINED WITHIN THIS SUBMISSION PACKAGE. WORKS BEYOND THIS POINT TIE INTO PICARDY PLACE PROPOSALS

KEY

- AREAS TO BE REDETERMINED**
-  CARRIAGEWAY TO FOOTWAY
1,2,4,5,8,9,14,15,17
 -  FOOTWAY TO CARRIAGEWAY
3,6,7,18
 -  VERGE TO FOOTWAY
11
 -  FOOTWAY TO CYCLE TRACK
12,13
 -  CARRIAGEWAY TO CYCLE TRACK
10,16

05	REDETERMINATION AREAS REVISED	JL	ED	NH	07/07/17
04	NUMBERED AREAS ADDED TO THE KEY	JL	ED	NH	28/08/17
03	REDETERMINATION AREAS REVISED	JL	ED	NH	22/08/17
02	DRAWING DIVIDED IN 4 SHEETS AND NOTES REVISED	JL	ED	NH	15/08/17
01	ISSUED FOR REVIEW / APPROVAL	JL	ED	NH	08/08/17
REV	AMENDMENTS	BY	CHKD	APRD	DATE

Client **TH Real Estate**
 Project **EDINBURGH ST JAMES**
 PUTTING EDINBURGH FIRST

SWECO
 Spectrum House
 2 Powderhall Road
 Edinburgh
 EH7 4GB
 Tel: +44 (0)131 550 6300
 www.sweco.co.uk



This drawing should not be relied on or used in circumstances other than those for which it was originally prepared and for which Sweco was commissioned. Sweco accepts no responsibility for this drawing for any party other than the person by whom it was commissioned. This drawing has been prepared for the stated project or named part thereof and should not be relied upon or used for any other project without an independent check being carried out as to its suitability and prior written authority of Sweco being obtained. Sweco accepts no responsibility or liability for the consequences of this drawing being used for a purpose other than the purposes for which it was commissioned. Any person using or relying on this drawing for such other purpose agrees, and will by such use or reliance be taken to confirm his agreement, to indemnify Sweco for all loss or damage resulting therefrom.

Title **LEITH STREET REDETERMINATION ORDER SHEET 1 OF 3**

Scale 1:500 @ A4	Drawing No.	Rev.
Drawn JL Date 15/06/17	ESJ-SWE-Z1-XXX-OR-TR-02702	05
Chkd ED Date 15/06/17		
Appd NH Date 15/06/17		

KEY

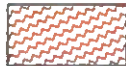
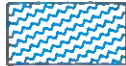
AREAS TO BE REDETERMINED

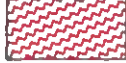
-  CARRIAGEWAY TO FOOTWAY
1,2,4,5,8,9,14,15,17
-  FOOTWAY TO CARRIAGEWAY
3,6,7,18
-  VERGE TO FOOTWAY
11
-  FOOTWAY TO CYCLE TRACK
12,13
-  CARRIAGEWAY TO CYCLE TRACK
10,16

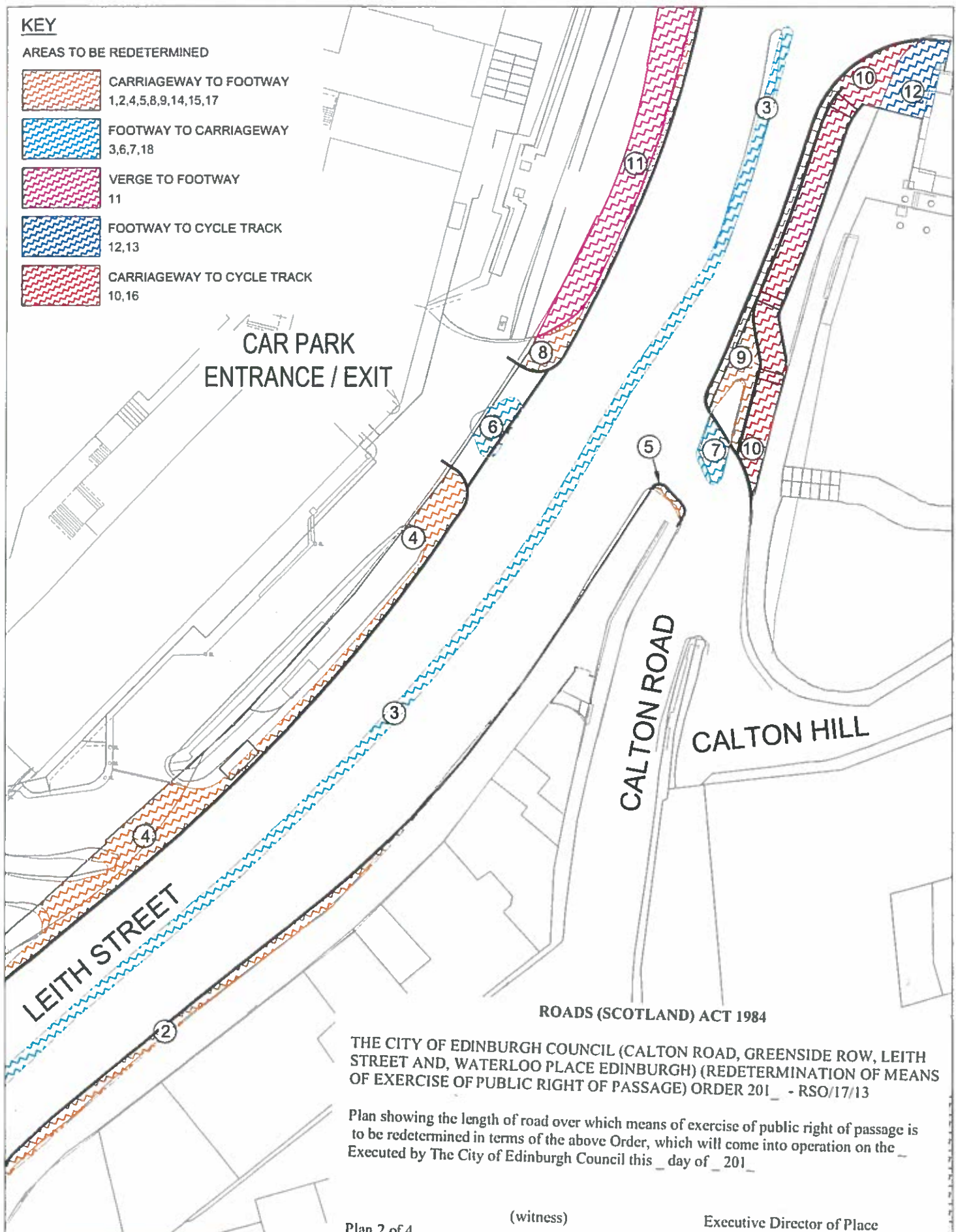

THE CITY OF EDINBURGH COUNCIL (CALTON ROAD, GREENSIDE ROW, LEITH STREET AND, WATERLOO PLACE EDINBURGH) (REDETERMINATION OF MEANS OF EXERCISE OF PUBLIC RIGHT OF PASSAGE) ORDER 201_ - RSO/17/13

Plan showing the length of road over which means of exercise of public right of passage is to be redetermined in terms of the above Order, which will come into operation on the Executed by The City of Edinburgh Council this _ day of _ 201_

Plan 2 of 4 (witness) Executive Director of Place

Client **TH Real Estate**
 Project **EDINBURGH StJAMES**
 PUTTING EDINBURGH FIRST

SWECO
 Spectrum House
 2 Powderhall Road
 Edinburgh EH7 4GB
 Tel: +44 (0)131 550 6300
 www.sweco.co.uk

This drawing should not be relied on or used in circumstances other than those for which it was originally prepared and for which Sweco was commissioned. Sweco accepts no responsibility for the drawing to any party other than the person by whom it was commissioned. This drawing has been prepared for the titled project or named part thereof and should not be relied upon or used for any other project without an independent check being carried out as to its suitability and prior written authority of Sweco being obtained. Sweco accepts no responsibility or liability for the consequences of the drawing being used for a purpose other than the purposes for which it was commissioned. Any person using or relying on this drawing for such other purpose agrees, and will by such use or reliance be taken to confirm his agreement, to indemnify Sweco for all loss or damage resulting therefrom.

Title LEITH STREET REDETERMINATION ORDER SHEET 2 OF 3		Drawing No.	Rev.
Scale 1:500 @ A4	Date 15/06/17	ESJ-SWE-Z1-XXX-DR-TR-02703	07
Drawn JL	Date 15/06/17		
Chkd ED	Date 15/06/17		
Appd NH	Date 15/06/17		

KEY

AREAS TO BE REDETERMINED

-  CARRIAGEWAY TO FOOTWAY
1,2,4,5,8,9,14,15,17
-  FOOTWAY TO CARRIAGEWAY
3,6,7,18
-  VERGE TO FOOTWAY
11
-  FOOTWAY TO CYCLE TRACK
12,13
-  CARRIAGEWAY TO CYCLE TRACK
10,16

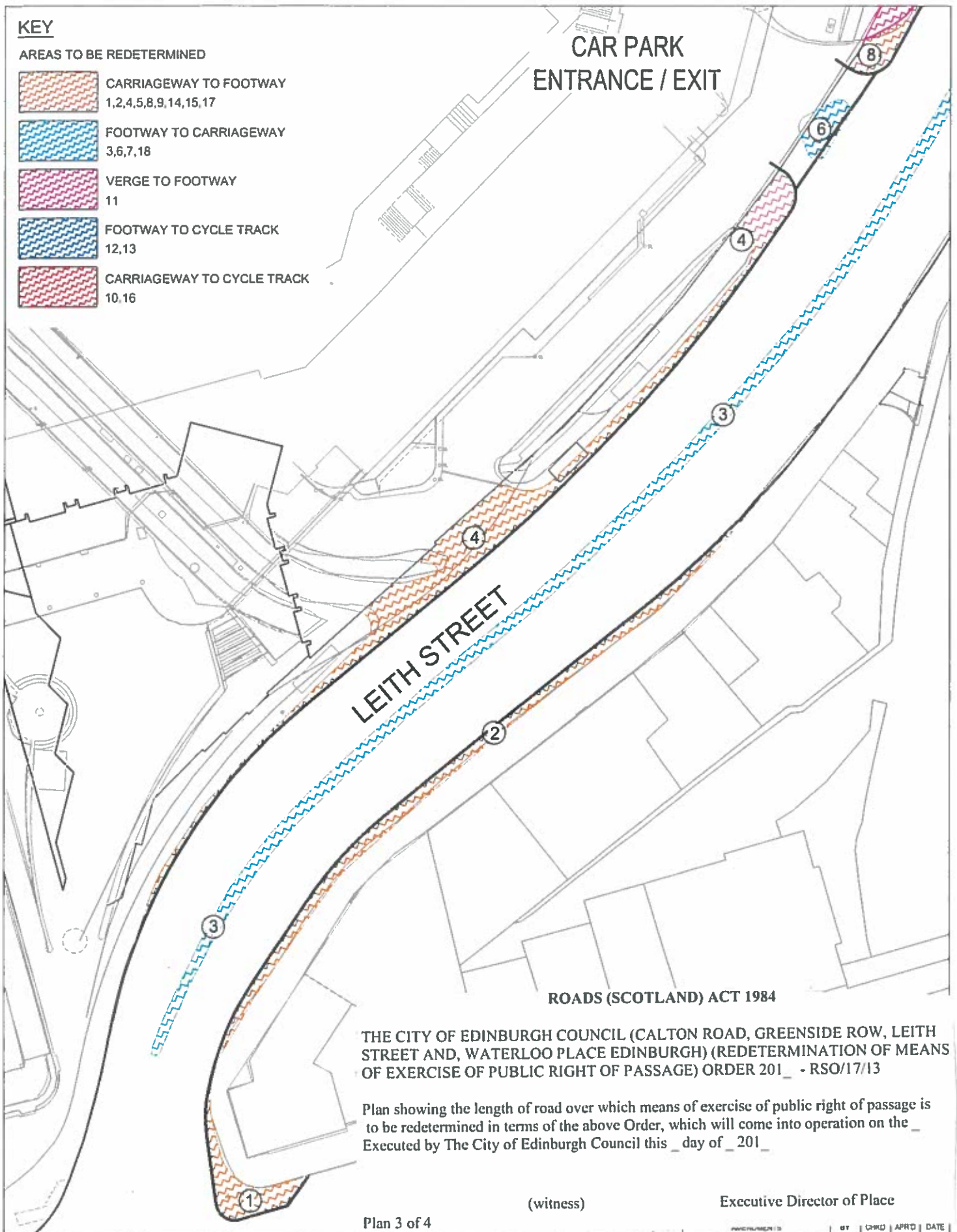

ROADS (SCOTLAND) ACT 1984

THE CITY OF EDINBURGH COUNCIL (CALTON ROAD, GREENSIDE ROW, LEITH STREET AND, WATERLOO PLACE EDINBURGH) (REDETERMINATION OF MEANS OF EXERCISE OF PUBLIC RIGHT OF PASSAGE) ORDER 201_ - RSO/17/13

Plan showing the length of road over which means of exercise of public right of passage is to be redetermined in terms of the above Order, which will come into operation on the _ Executed by The City of Edinburgh Council this _ day of _ 201_

(witness)

Executive Director of Place

Plan 3 of 4

Client **TH Real Estate**
 Project **EDINBURGH ST JAMES**
 PUTTING EDINBURGH FIRST

SWECO
 Spectrum House
 2 Powderhall Road
 Edinburgh
 EH7 4GB
 Tel: +44 (0)131 550 6300
 www.sweco.co.uk



This drawing should not be relied on or used in circumstances other than those for which it was originally prepared and for which Sweco was commissioned. Sweco accepts no responsibility for this drawing to any party other than the person by whom it was commissioned. This drawing has been prepared for the titled project or named part thereof and should not be relied upon or used for any other project without an independent check being carried out as to its suitability and prior written authority of Sweco being obtained. Sweco accepts no responsibility or liability for the consequences of this drawing being used for a purpose other than the purposes for which it was commissioned. Any person using or relying on this drawing for such other purpose agrees, and will by such use or reliance be taken to confirm his agreement, to indemnify Sweco for all loss or damage resulting therefrom.

Title		LEITH STREET REDETERMINATION ORDER SHEET 3 OF 3	
Scale	1:500 @ A4	Drawing No.	ESJ-SWE-21-XXX-DR-TR-02704
Drawn	JL Date 15/06/17	Rev.	07
Chkd	ED Date 15/06/17		
Appd	NH Date 15/06/17		

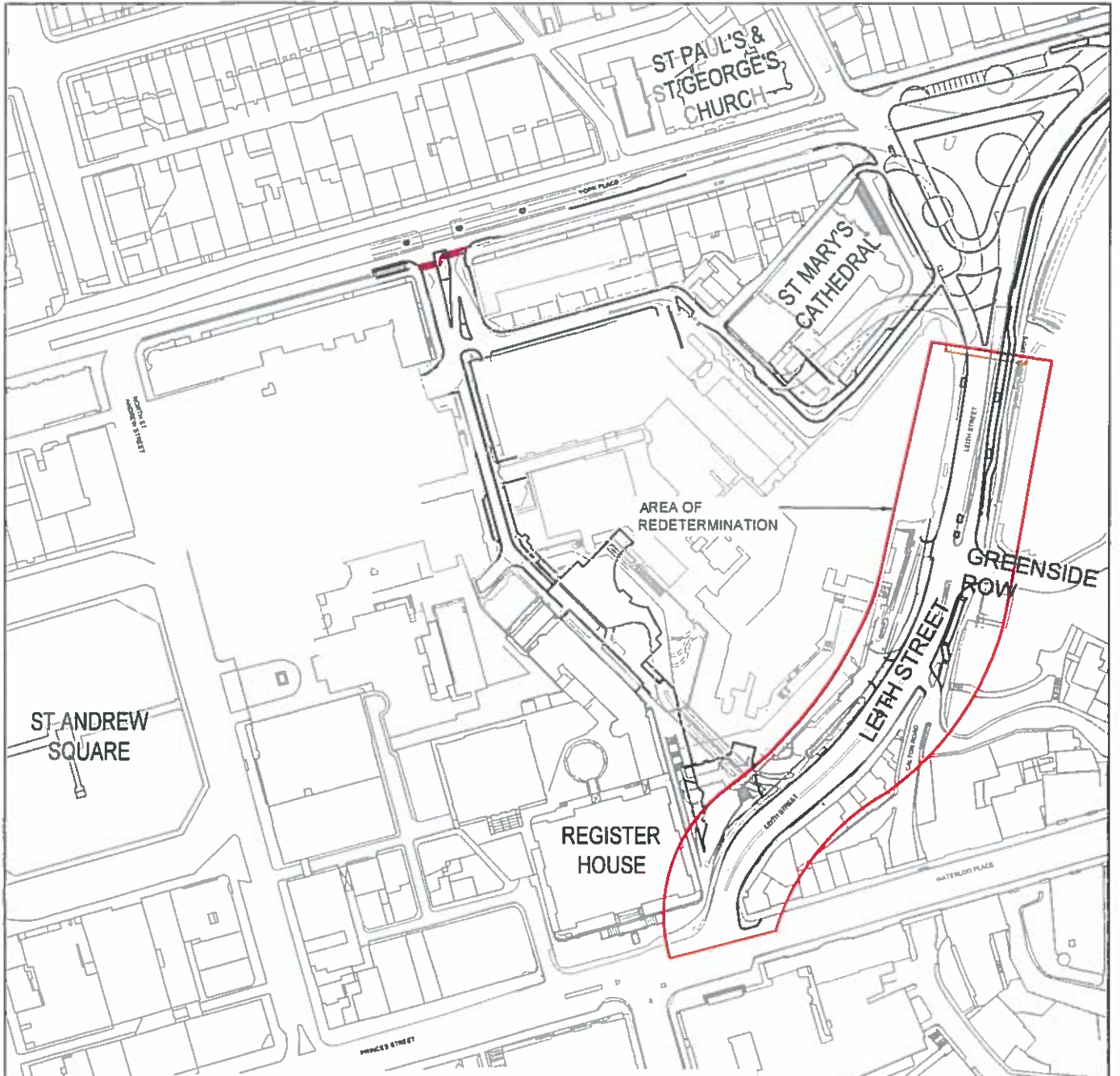

ROADS (SCOTLAND) ACT 1984

THE CITY OF EDINBURGH COUNCIL (CALTON ROAD, GREENSIDE ROW, LEITH STREET AND, WATERLOO PLACE EDINBURGH) (REDETERMINATION OF MEANS OF EXERCISE OF PUBLIC RIGHT OF PASSAGE) ORDER 201_ - RSO/17/13

Site Location Plan for the above Order which will come into effect on _day of 201_ .
 Executed by The City of Edinburgh Council this _day of _ 201_

Plan 4 of 4

(witness)

Executive Director of Place

WAVERLEY STATION

LOCATION PLAN (SCALE 1:2500)

03	REDETERMINATION AREAS REVISED	JL	ED	NH	23/08/17
02	DRAWING DIVIDED IN 4 SHEETS AND NOTES REVISED	JL	ED	NH	15/08/17
01	ISSUED FOR REVIEW / APPROVAL	JL	ED	NH	28/06/17
REV	AMENDMENTS	BY	CHKD	APRD	DATE

Client **TH Real Estate**
 Project **EDINBURGH St JAMES**
 PUTTING EDINBURGH FIRST

SWECO
 Spectrum House
 2 Powderhall Road
 Edinburgh
 EH7 4GB
 Tel: +44 (0)131 550 6300
 www.sweco.co.uk

This drawing should not be relied on or used in circumstances other than those for which it was originally prepared and for which Sweco was commissioned. Sweco accepts no responsibility for the drawing to any party other than the person by whom it was commissioned. This drawing has been prepared for the stated project or named part thereof and should not be relied upon or used for any other project without an independent check being carried out as to its suitability and prior written authority of Sweco being obtained. Sweco accepts no responsibility or liability for the consequences of the drawing being used for a purpose other than the purposes for which it was commissioned. Any person using or relying on the drawing for such other purposes agrees, and will by such use or reliance be taken to confirm his agreement, to indemnify Sweco for all loss or damage resulting therefrom.

Title			
LEITH STREET REDETERMINATION ORDER LOCATION PLAN			
Scale 1:2500 @ A4	Drawing No	Rev.	
Drawn JL Date 15/08/17	ESJ-SWE-21-XXX-DR-TR-0270	03	
Chkd ED Date 15/08/17			
Appd NH Date 15/08/17			