

EXISTING PLAN

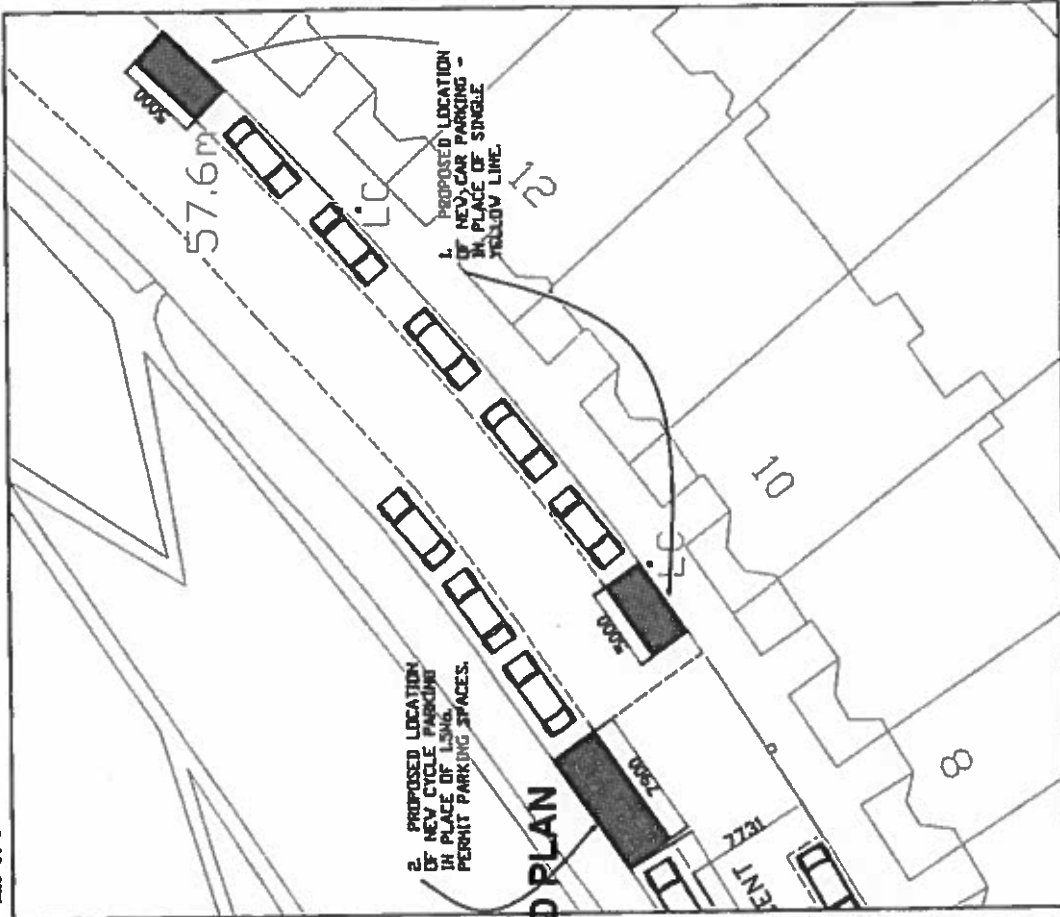

PROPOSED PLAN

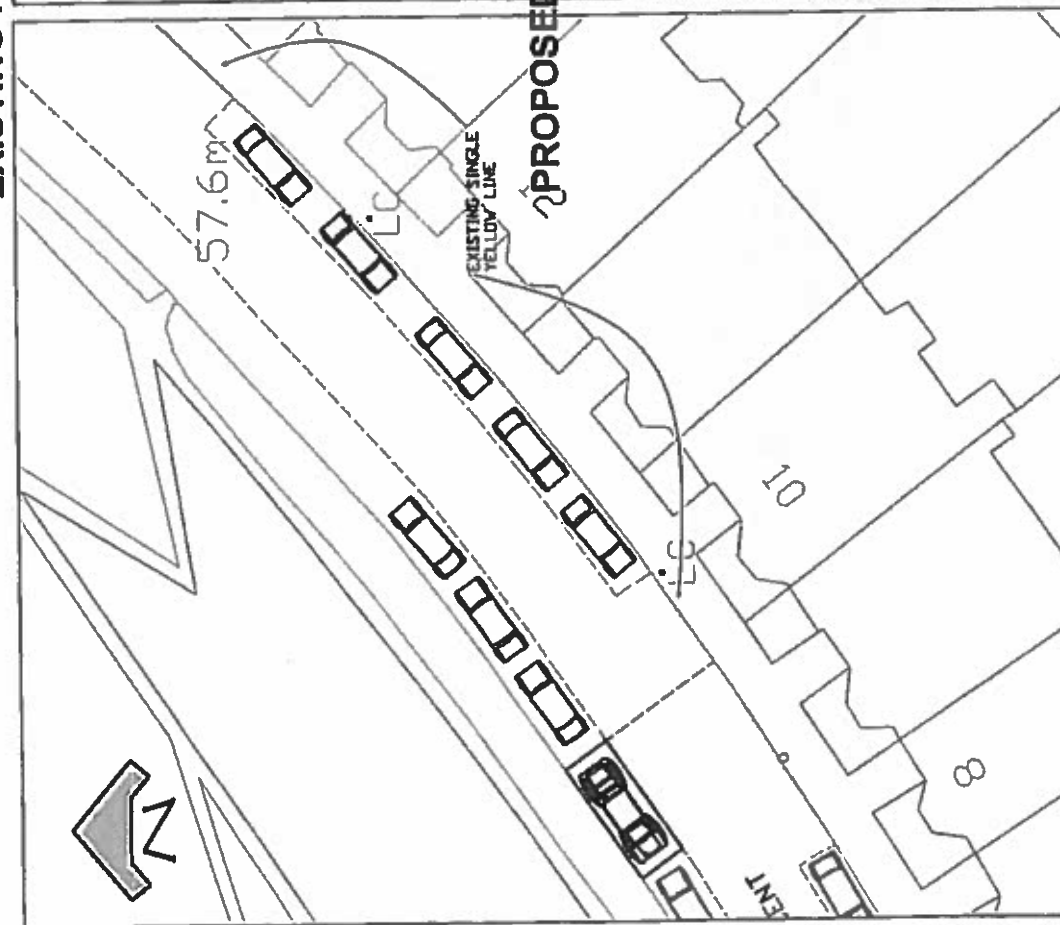

- SUMMARY OF PROPOSED CHANGES:**
1. 10m single yellow line to be removed to allow for new permit parking spaces.
 2. 2 X Permit car parking spaces reassigned as cycle parking.
 3. Overall loss of 0 car parking spaces

EDINBURGH
THE CITY OF EDINBURGH COUNCIL

SERVICES FOR COMMUNITIES
The City of Edinburgh Council
City Chambers, High Street
Edinburgh EH1 1YJ
Tel No 0131 200 2000

TRANSPORT
TRAFFIC & ENGINEERING
TRANSPORT POLICY
Cycle Team

Cycle Parking Pilot Scheme
Douglas Crescent

Date: Apr 2013
Scale: RTS

Drawn by: AT
Checked by: AT

DRG NO. P9_4_001_TRO_DC.

Drawing Name: C:\CD\1\res\1\res\reson\pilot\cycle\cycle_scheme\p9_4_001\Resonated bus parking\pilot\pilot\pilot\DouglasCrescent TRO.dwg

EXISTING PLAN

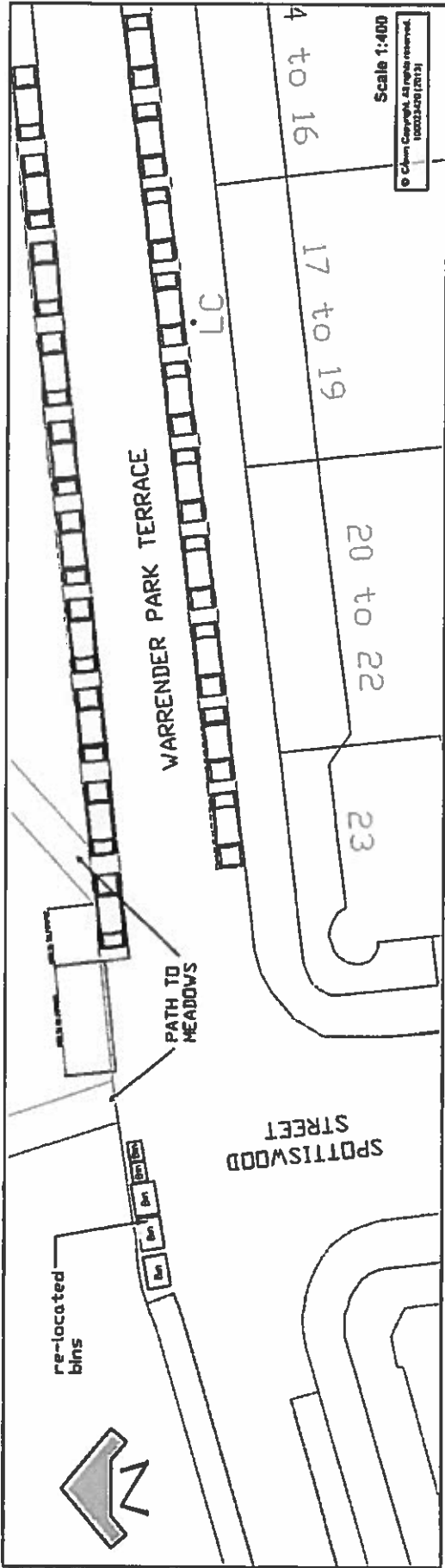

PROPOSED PLAN

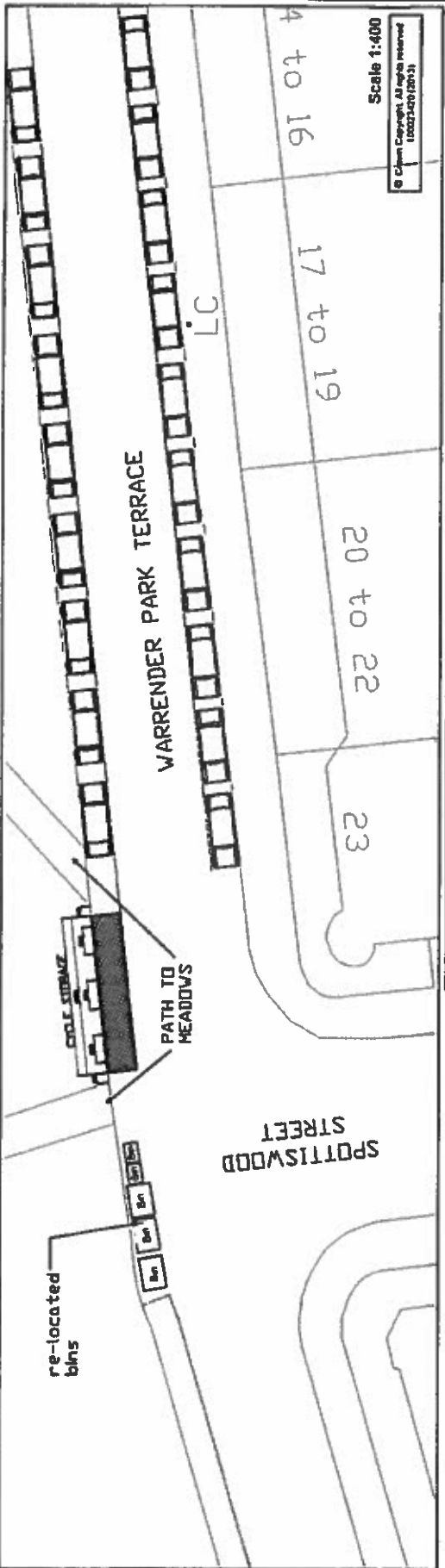

SUMMARY OF PROPOSED CHANGES:

- 3.9m permit parking zone to be removed and
- 7.6m single yellow line to be removed to allow for new Cycle parking units.
- Overall loss of 1 permit car parking space.

EDINBURGH
THE CITY OF EDINBURGH COUNCIL

SERVICES FOR COMMUNITIES
The City of Edinburgh Council
City Chambers, High Street
Edinburgh EH1 1YJ
Tel No 0131 200 2000

TRANSPORT
TRAFFIC & ENGINEERING
TRANSPORT POLICY
Cycle Team

CYCLE PARKING_PILOT_SCHEME
18_WARRENDER_PARK_TERRACE

Date: OCT_13
Scale: 1:400

Drawn by: AT
Checked by: AT

DRG NO.P9_4_001_TRO_18WPT

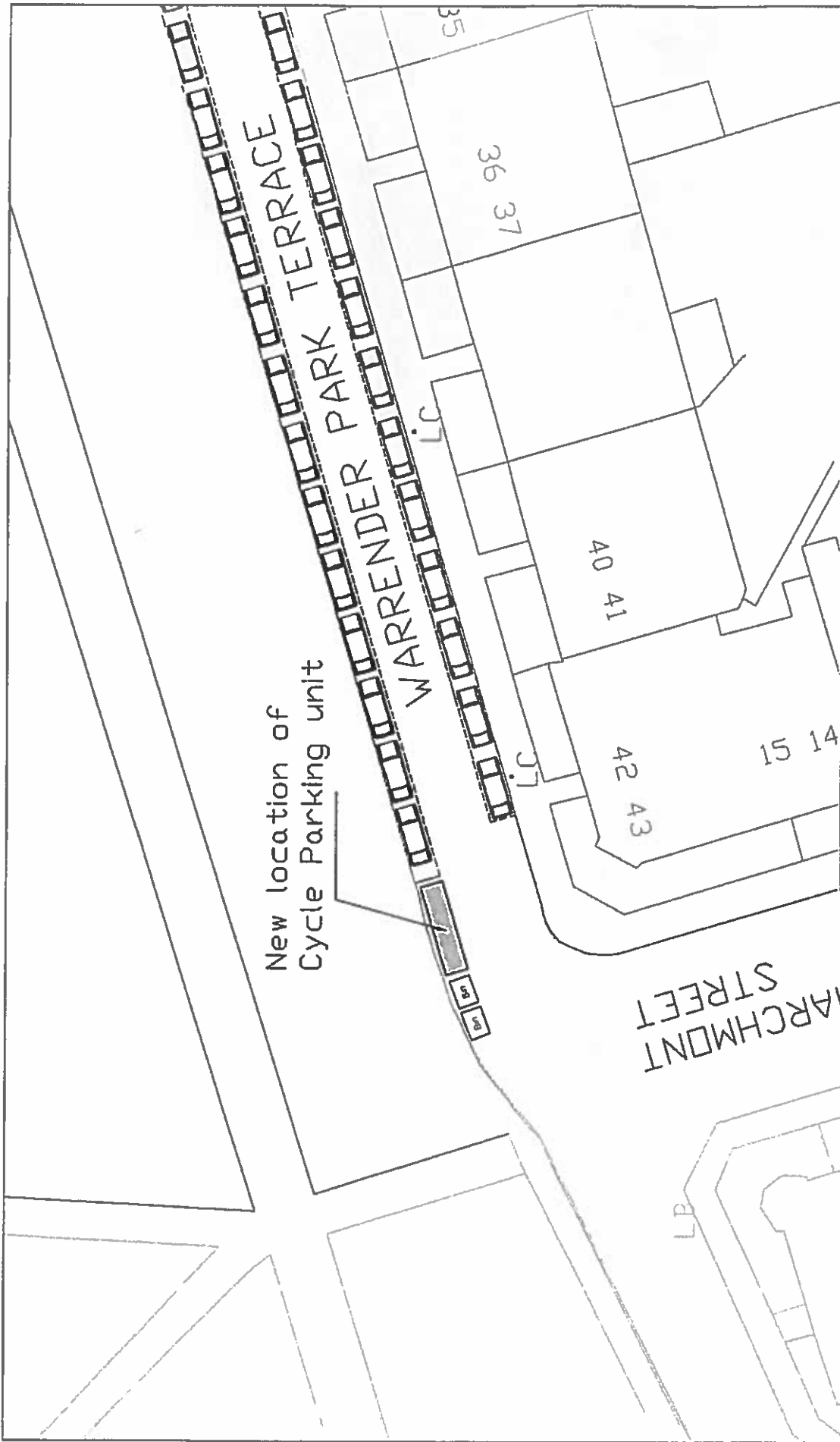

New location of
Cycle Parking unit

WARRENDER PARK TERRACE

MARCHMONT STREET



On-street Cycle Parking Pilot
41 Warrender Park Terrace

• EDINBURGH •
THE CITY OF EDINBURGH COUNCIL

Date: SEP-13
Scale: A-100
Drawn by: PDW
Checked by: CHECKED

TRANSPORT
ROAD SAFETY

SERVICES FOR COMMUNITIES
The City of Edinburgh Council
Waverly Court, 4 East Market Street
Edinburgh, EH1 1TG
Tel. No. 0131 - 200 2000

DRG NO.

© Crown Copyright. All rights reserved.
10002300 (03/13)

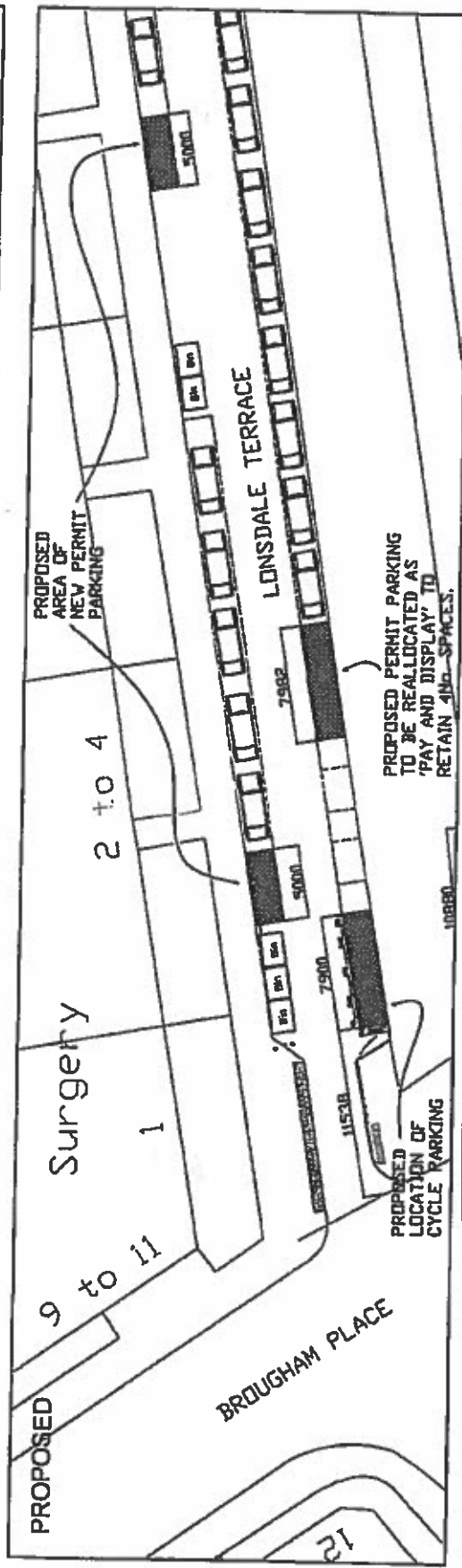
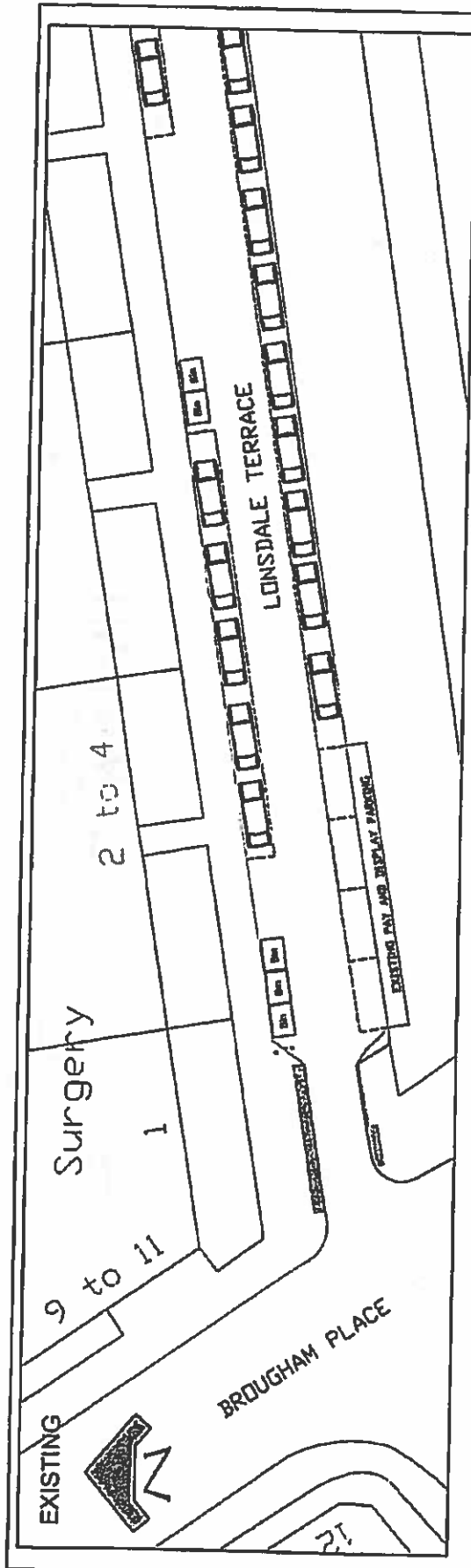

NOTES:
 Proposed Scheme to provide parking for up to 10No. Bikes.
 Amendment to existing CP2, TRO under Sections 32, 35 & 53 of the RTRA 1984.

- Cycle Parking
- Pay and Display Parking
- Proposed New Building Footprint
- Existing Building Footprint
- Proposed New Parking
- Existing Parking
- Proposed New Cycle Path
- Existing Cycle Path

EDINBURGH
 THE CITY OF EDINBURGH COUNCIL

SERVICES FOR COMMUNITIES
 The City of Edinburgh Council
 City Chambers, High Street
 Edinburgh EH1 1YJ
 Tel: 0131 200 2000

TRANSPORT & ENGINEERING
 TRANSPORT POLICY
 Cycle Team

Cycle Parking Pilot Scheme
 Lonsdale Terrace

Date: April 2013
 Scale: A3

Drawn by: AT
 Checked by: AT

DRG NO. P9_4_001_TRO_LONS

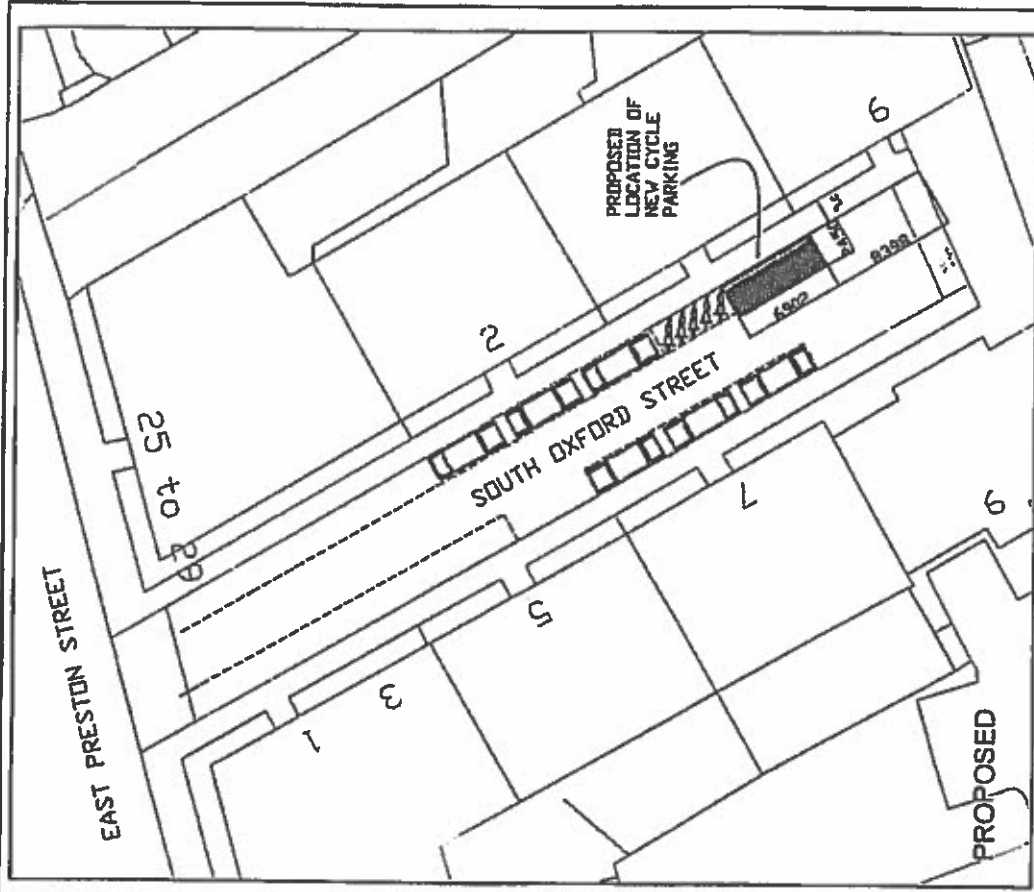
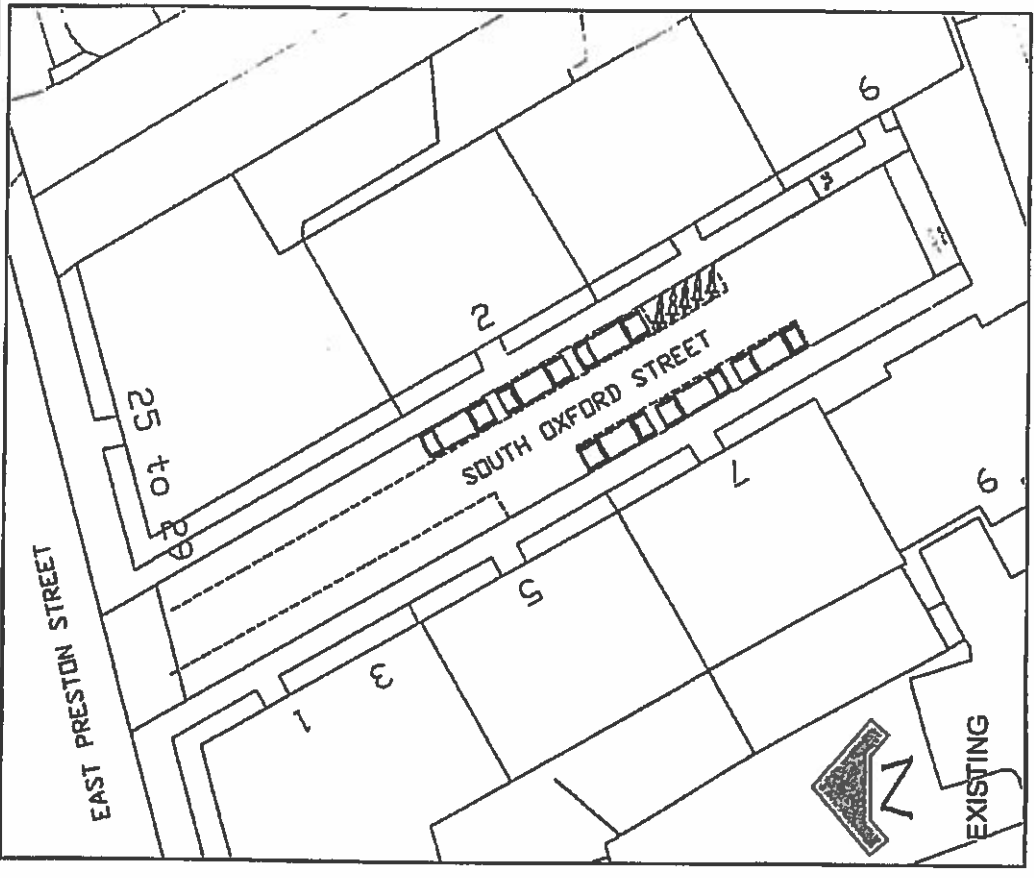

NOTES:

Proposed Scheme to provide parking for up to 15 No. Bikes.
 Amendment to existing CPZ TRO under Sections 32, 35 & 63 of the RTRA 1984.

- 15 No. Bikes
- 15 No. Motorcycles
- 15 No. Motorcycles
- 15 No. Motorcycles
- 15 No. Motorcycles
- 15 No. Motorcycles
- 15 No. Motorcycles
- 15 No. Motorcycles

EDINBURGH
 THE CITY OF EDINBURGH COUNCIL

SERVICES FOR COMMUNITIES
 The City of Edinburgh Council
 City Chambers, High Street
 Edinburgh EH1 1YJ
 Tel No 0131 200 2000

TRANSPORT
 TRAFFIC & ENGINEERING
 TRANSPORT POLICY
 Cycle Team

Cycle Parking Pilot Scheme
 South Oxford Street

Date: April 2013
 Scale: 1:175

Drawn by: AT
 Checked by: AT

DRG NO. Pg_4_001_TRO_SOS

Drawing Name: Q:\C:\b\1\amendment_UnderCPZofCYCLE_SOS\EDINBURGH_Cycle_Parking_Plan_4_001.dwg