

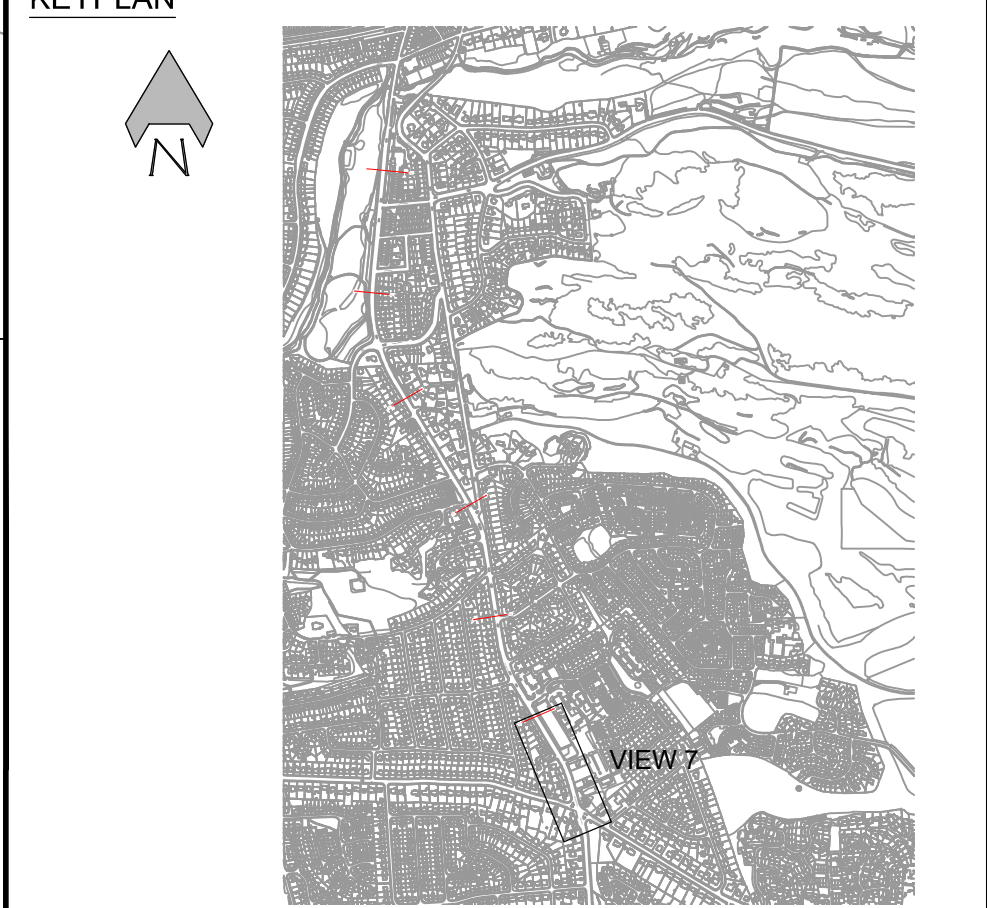

- NOTES:
- ALL DIMENSIONS ARE IN METRES UNLESS OTHERWISE STATED.
  - REFER TO DRAWING COM-12727-1100-01 FOR CONSTRUCTION DETAILS OF FLOATING BUS STOPS AND ORCA WANDS.
  - THIS DRAWING IS TO BE READ IN CONJUNCTION WITH ALL RELEVANT DOCUMENTS.
  - TSRGD REFERS TO TRAFFIC SIGNS REGULATIONS AND GENERAL DIRECTIONS 2016.
- KEY - PROPOSED MARKINGS AND EQUIPMENT
- STOP LINE - 200mm TO TSRGS DIA. 1001
  - GIVE WAY MARKINGS - 150mm TO TSRGD DIA. 1003
  - EDGE LINE 150mm WIDE TO TSRGD DIA. 1009
  - WARNING LINE - 4m LINE, 2m GAP 100mm WIDE TO TSRGD DIA. 1004
  - EDGE LINE 100mm WIDE - 1m LINE, 1m GAP - TSRGD DIA. 1010
  - MANDATORY CYCLE LANE - 150mm WIDE TSRGD DIA. 1049
  - NO WAITING RESTRICTIONS AT ANY TIME TSRGD DIA. 1018.1
  - NO LOADING AT ANY TIME RESTRICTIONS TSRGD DIA. 1020.1
  - NO LOADING AT TIMES SHOWN TSRGD DIA. 1019
  - ZIG ZAG MARKINGS TO TSRGD DIA. 1001.3
  - CYCLE MARKING SIZE 2750mm TSRGD DIA. 1057
  - CYCLE MARKING SIZE 1215mm TSRGD DIA. 1057
  - HATCH TSRGD DIA. 1040
  - HIGH FRICTION SURFACING - COLOUR RED
  - TEMPORARY BUS STOP PADS SEE DRAWING COM-12727-1100-01
  - GREENWICH WAND ORCA 2.5m LONG LAID AT 5.0m SPACINGS - SEE DRAWING COM-12727-1100-01
  - APPROXIMATE DRIVEWAY LOCATIONS - ORCAS NOT TO BE PLACED OVER DRIVEWAYS OR ACCESS POINTS



GREENWICH ORCA WANDS - 2.5m LONG  
SEE DRAWING COM-12727-1100-01 FOR CONSTRUCTION DETAILS  
<http://www.rediweldtraffic.co.uk/products/cycle-lane-products/greenwich-wand-orca/>



REDIWELD BUSPAD - TO BE LOCATED ON CARRIAGEWAY WHERE STATED  
SEE DRAWING COM-12727-1100-01 FOR CONSTRUCTION DETAILS  
<http://www.rediweldtraffic.co.uk/products/inclusive-mobility/buspad/>



VECTORIAL FLOATING BUS STOP -  
ONE TO BE LOCATED NEW CAMUS AVE - OTHERWISE REDIWELD BUSPADS  
SEE DRAWING COM-12727-1100-01 FOR CONSTRUCTION DETAILS  
<https://www.zicla.com/en/vectorial-system/>

IMPORTANT

SWECO

HEALTH, SAFETY & ENVIRONMENTAL INFORMATION

IN ADDITION TO THE HAZARDS AND RISKS NORMALLY ASSOCIATED WITH THE TYPE OF WORK DETAILED ON THIS DRAWING, PLEASE NOTE THE FOLLOWING SIGNIFICANT RISKS TO HEALTH, SAFETY & ENVIRONMENT:

THE SIGNIFICANT RISKS ASSOCIATED WITH THE PROJECT ARE NOTED BELOW

There are No Significant Residual Risks For This Element

NO SIGNIFICANT UNUSUAL OR DIRECTED RISKS THAT ACCOMPANY CONTRACTOR WOULD NOT BE AWARE OF ARE NOTED FOR THE WORKS ASSOCIATED WITH THIS DESIGN ELEMENT. FOR RISKS IDENTIFIED DURING THE DESIGN STAGE PLEASE REFER TO THE COMSTON ROAD DESIGNER'S RISK ASSESSMENT

SWECO COMSTON ROAD DESIGNER'S RISK ASSESSMENT

IT IS ASSUMED THAT ALL WORKS SHALL BE UNDERTAKEN BY A COMPETENT CONTRACTOR WORKING WHERE APPROPRIATE TO AN APPROVED SAFE SYSTEM OF WORK

sustrans

JOIN THE MOVEMENT

SWECO

REVISION	DETAILS	BY	DATE	CHECKED

• EDINBURGH •  
THE CITY OF EDINBURGH COUNCIL

The City of Edinburgh Council  
Waverley Court  
4 East Market Street  
Edinburgh, EH8 8BG  
Telephone: 0131 200 2000

PLANNING  
PERMIT  
TRANSPORT  
SIGNALS & DELIVERY

SPACES FOR PEOPLE  
COMSTON ROAD  
1200 ROAD MARKING LAYOUT  
SHEET 4 OF 4

DATE: 12/02/2020  
SCALE: 1:500  
JOB NO.: 12727

Drawn by: SWECO - AMCN  
Checked by: SWECO - AB  
Reviewed by: SWECO - CF

DRG. NO. COM-12727-1200-04