

Notes:

1. THIS DRAWING IS TO BE READ IN CONJUNCTION WITH ALL OTHER RELEVANT DRAWINGS, DOCUMENTATION, SPECIFICATION AND APPENDICES PROVIDED.
2. ALL DIMENSIONS ARE IN METRES UNLESS OTHERWISE STATED.
3. NO TOPOGRAPHICAL INFORMATION AVAILABLE FOR THIS SCHEME. BACKGROUND INFORMATION AS PER OS MAP TILES PROVIDED BY CLIENT (SEE ALSO NOTE 4 BELOW).
4. EXISTING CARRIAGEWAY WIDTHS, KERB LINES AND CROSSING LOCATIONS ARE INDICATIVE AND WILL BE CONFIRMED ON SITE BEFORE COMMENCING CONSTRUCTION WORKS.
5. PROPOSED TEMPORARY MEASURES TO BE CONFIRMED DURING SETTING OUT BY SUPERVISING ENGINEER.
6. ALL MARKING LOCATIONS AND DIMENSIONS ARE ESTIMATES.
7. TAKE OFF MARKINGS WILL BE SUBJECT TO A SEPARATE SET OF DRAWINGS.
8. SIGN MATERIAL CLASS IS INDICATIVE. CEC TO DETERMINE FINAL CLASS.
9. LOCATIONS OF SIGNS TO DIAGRAM 7014 ARE INDICATIVE ONLY. LOCATIONS ARE TO BE DETERMINED ON SITE.
10. REQUIREMENTS FOR CLEARANCE OF VEGETATION TO BE ASSESSED ON SITE.

<p>Jacobs</p> <p>160 Dundee Street, Edinburgh, EH11 1DQ Tel: +44 (0)131 659 Fax: +44 (0)131 228 6177 www.jacobs.com</p>	
Client	<p>• € DINBURGH •</p> <p>THE CITY OF EDINBURGH COUNCIL</p>
Project	<p>Bus Priority</p> <p>Rapid Deployment Fund</p> <p>SES06</p>

Drawing title <div style="text-align: center; font-size: 1.5em; font-weight: bold; margin-top: 10px;"> TEMPORARY BUS LANE ON A89 EASTBOUND APPROACH TO NEWBRIDGE </div>	
Drawing status <div style="text-align: center; font-size: 1.2em; font-weight: bold; margin-top: 10px;"> FOR CONSTRUCTION </div>	
Scale	1:500 @ A1
Jacobs No.	
Client no.	
Drawing number <div style="text-align: center; font-size: 1.5em; font-weight: bold; margin-top: 10px;"> BPRDF-SES06-GA-0001 </div>	

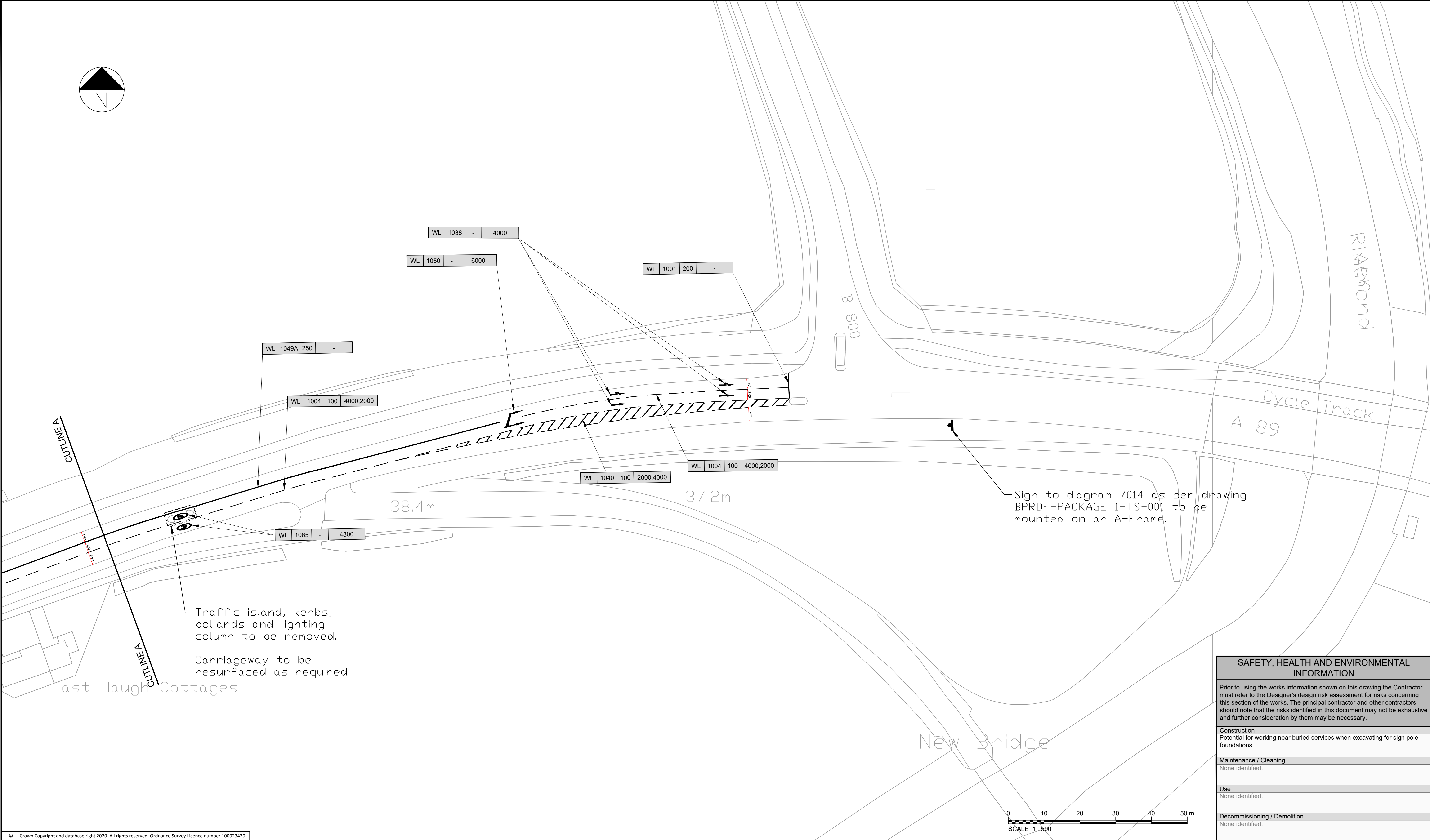

© Crown Copyright and database right 2020. All rights reserved. Ordnance Survey Licence number 100023420.						
0	03/03/2021	FOR CONSTRUCTION	DC	MH	KV	CS
Rev	Rev. Date	Purpose of revision	Des'd	Checked	Rev'd	Apprv'd
© Copyright 2018 Jacobs U.K. Limited. The concepts and information contained in this document are the property of Jacobs. Use or copying of this document in whole or in part without the written permission of Jacobs constitutes an infringement of copyright. Limitation: This drawing has been prepared on behalf of, and for the exclusive use of Jacobs' Client, and is subject to, and issued in accordance with, the provisions of the contract between Jacobs and the Client. Jacobs accepts no liability or responsibility whatsoever for, or in respect of, any use of, or reliance upon, this drawing by any third party.						

- Notes:
1. THIS DRAWING IS TO BE READ IN CONJUNCTION WITH ALL OTHER RELEVANT DRAWINGS, DOCUMENTATION, SPECIFICATION AND APPENDICES PROVIDED.
 2. ALL DIMENSIONS ARE IN METRES UNLESS OTHERWISE STATED.
 3. NO TOPOGRAPHICAL INFORMATION AVAILABLE FOR THIS SCHEME. BACKGROUND INFORMATION AS PER OS MAP TILES PROVIDED BY CLIENT (SEE ALSO NOTE 4 BELOW).
 4. EXISTING CARRIAGEWAY WIDTHS, KERB LINES AND CROSSING LOCATIONS ARE INDICATIVE AND WILL BE CONFIRMED ON SITE BEFORE COMMENCING CONSTRUCTION WORKS.
 5. PROPOSED TEMPORARY MEASURES TO BE CONFIRMED DURING SETTING OUT BY SUPERVISING ENGINEER.
 6. ALL MARKING LOCATIONS AND DIMENSIONS ARE ESTIMATES.
 7. TAKE OFF MARKINGS WILL BE SUBJECT TO A SEPARATE SET OF DRAWINGS.
 8. SIGN MATERIAL CLASS IS INDICATIVE. CEC TO DETERMINE FINAL CLASS.
 9. LOCATIONS OF SIGNS TO DIAGRAM 7014 ARE INDICATIVE ONLY. LOCATIONS ARE TO BE DETERMINED ON SITE.
 10. REQUIREMENTS FOR CLEARANCE OF VEGETATION TO BE ASSESSED ON SITE.

Key

- PROPOSED WHITE ROAD MARKINGS
- PROPOSED YELLOW ROAD MARKINGS
- EXISTING ROAD MARKINGS
- TRAFFIC SIGNS

TSRGD Reference Number

Marking Colour
WL-White Line
YL-Yellow Line

Line Width (mm)

Road Marking Detail
Line-(line, gap/continuous)
Marking/roundel-(length)
Text-(height)

WL 1004 100 4000,2000

Jacobs
160 Dundee Street, Edinburgh, EH11 1DQ
Tel: +44 (0)131 659 Fax: +44 (0)131 228 6177
www.jacobs.com

Client

EDINBURGH
THE CITY OF EDINBURGH COUNCIL

Project

Bus Priority
Rapid Deployment Fund
SES06

SAFETY, HEALTH AND ENVIRONMENTAL INFORMATION

Prior to using the works information shown on this drawing the Contractor must refer to the Designer's design risk assessment for risks concerning this section of the works. The principal contractor and other contractors should note that the risks identified in this document may not be exhaustive and further consideration by them may be necessary.

Construction
Potential for working near buried services when excavating for sign pole foundations

Maintenance / Cleaning
None identified.

Use
None identified.

Decommissioning / Demolition
None identified.

Drawing title

**TEMPORARY BUS LANE ON A89
EASTBOUND APPROACH TO
NEWBRIDGE**

Drawing status

FOR CONSTRUCTION

Scale 1:500 @ A1 DO NOT SCALE

Jacobs No. Rev 0

Client no.

Drawing number

BPRDF-SES06-GA-0002