

Do not scale from this drawing.

SAFETY HEALTH AND ENVIRONMENTAL INFORMATION

IN ADDITION TO THE HAZARD/RISKS NORMALLY ASSOCIATED WITH THE TYPES OF WORK DETAILED IN THIS DRAWING, NOTE THE FOLLOWING RISKS AND INFORMATION:
IDENTIFIED RISKS ARE NOTED IN ETYN-SEF-XXX-XX-HS-20001 DD. RISK REGISTER REFER TO RISK REGISTER FOR MITIGATION MEASURES. RISKS ASSOCIATED WITH THIS WORKS ELEMENT ARE AS FOLLOWS

| REF. | NAME |
|------|---|
| 2 | Design Criteria |
| 21 | Utility Clashes with new tram infrastructure |
| 55 | Risk of injury to pedestrians/damage to road vehicles |
| 109 | Integration |
| 109 | Tramstops Road traffic |
| 110 | Tram/other users interface |
| 111 | Tram/other users interface |
| 112 | Tram/other users interface |

FOR INFORMATION RELATING TO USE, CLEANING AND MAINTENANCE SEE THE HEALTH AND SAFETY FILE.

IT IS ASSUMED THAT ALL WORKS WILL BE CARRIED OUT BY A COMPETENT CONTRACTOR WORKING, WHERE APPROPRIATE, TO AN APPROVED METHOD STATEMENT.

FINAL SETTING OUT ON SITE OF SIGNAL POLES SHALL BE SUBJECT TO CLAUSE 5.2005.16.03.22 OF THE PERFORMANCE SPECIFICATIONS: "THE EXACT POSITION OF ALL SIGNAL POLES SHALL BE AGREED WITH, AND MARKED OUT, IN THE PRESENCE OF THE SUPERVISOR AND REPRESENTATIVES FROM THE CITY OF EDINBURGH COUNCIL."

LOUVERED HOODS TO BE ADDED ON ALL KERBSIDE PEDESTRIAN HEADS. EXCEPT WHEN INDICATED, CENTRE OF THE POLES WILL BE LOCATED AT 0.690m FROM THE EDGE OF THE TACTILE PAVING.

LEGEND:

| | | | | | |
|------|--|------|-----------------------------------|------|--|
| (1) | POLE NUMBER | (C1) | MANHOLE NUMBER | (M) | MICROWAVE VEHICLE DETECTOR |
| (3) | 3-ASPECT PRIMARY SIGNALS WITH SUBSTITUTE GREEN ARROW SIGNALS | (D) | STOP LINE DETECTOR | (S) | ABOVE GROUND SCOOT DETECTOR |
| (4) | 3-ASPECT PRIMARY SIGNALS WITH ADDITIONAL GREEN ARROW SIGNALS | (E) | FARSIDE PEDESTRIAN HEAD SIGNAL | (T) | FARSIDE TOUCAN SIGNAL |
| (5) | 3-ASPECT WITH CYCLE GREEN | (F) | PEDESTRIAN SIGNAL AND DEMAND UNIT | (U) | 3-ASPECT SIGNAL WITH SECONDARY VISOR |
| (6) | ON CROSSING DETECTOR | (G) | TRAFFIC SIGNAL LANTERN | (V) | CYCLE HEAD |
| (7) | KERBSIDE DETECTOR | (H) | CYCLE HEAD LOW LEVEL | (W) | CYCLE HEAD EARLY |
| (8) | SOLAR CELL | (I) | CYCLE HEAD | (X) | GREEN 40x40 MANHOLE |
| (9) | PEDESTRIAN PUSH BUTTON AND AUDIBLE UNIT | (J) | 40x60 MANHOLE | (Y) | 60x60 MANHOLE (SHAWD W/ STREET LIGHTING) |
| (10) | TRAFFIC SIGNAL POLE (4.00m) | (K) | HALDO PILLAR | (Z) | INDUCTIVE LOOP |
| (11) | TRAFFIC SIGNAL POLE (2.00m) | (L) | OLE POLE | (AA) | OLE POLE |
| (12) | RJCC ROAD JUNCTION CONTROLLER CABIN | (M) | SIEMENS EQUIPMENT | (AB) | NO U TURN |
| (13) | TRAM SIGNAL LANTERN | (N) | NO U TURN EXCEPT BUSES | (AC) | NO LEFT TURN EXCEPT CYCLES |
| (14) | 1x100 INDUCTIVE DUCT | (O) | NO LEFT TURN | (AD) | AHEAD ONLY |
| (15) | 1x100 CHAMBER DUCT | (P) | NO LEFT TURN | (AE) | NO RIGHT TURN |

| Rev. | Date | Description | Drawn | Chkd. | Appd. |
|------|------------|-------------------------|--------|-------|--------|
| C02 | 11/05/2021 | ISSUED FOR CONSTRUCTION | U.P.L. | B.K. | L.Q.B. |
| C01 | 16/04/2021 | ISSUED FOR CONSTRUCTION | U.P.L. | B.K. | L.Q.B. |
| P01 | 04/09/2019 | FOR INFORMATION | A.L.G. | B.K. | L.Q.B. |



Project Title: **EDINBURGH TRAM YORK PLACE TO NEWHAVEN**

Drawing Title: **TRAFFIC SIGNALS LEITHWALK / PILRIG ST. J20 LAYOUT**

Sheet 23 of 31

| Scale of All: | Status: |
|---------------|------------------|
| 1:100 | FOR CONSTRUCTION |

| Drawn: | Checked: | Approved: |
|--------|----------|-----------|
| U.P.L. | B.K. | L.Q.B. |

Date: 17/05/2021 Date: 17/05/2021 Date: 17/05/2021

Project Originator Volume Location Type Role Number
ETYN-SEF-XXX-11-DR-N-0041

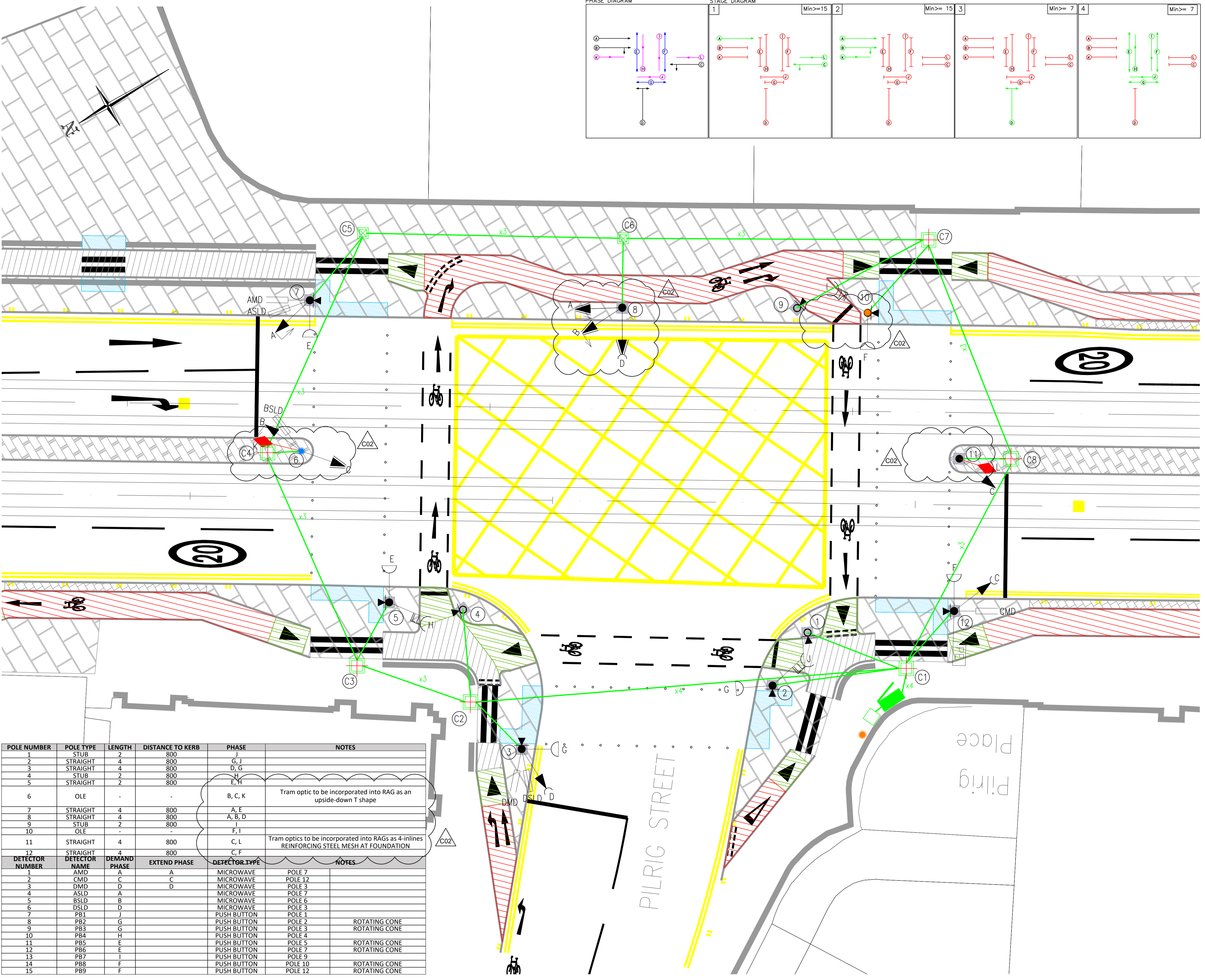
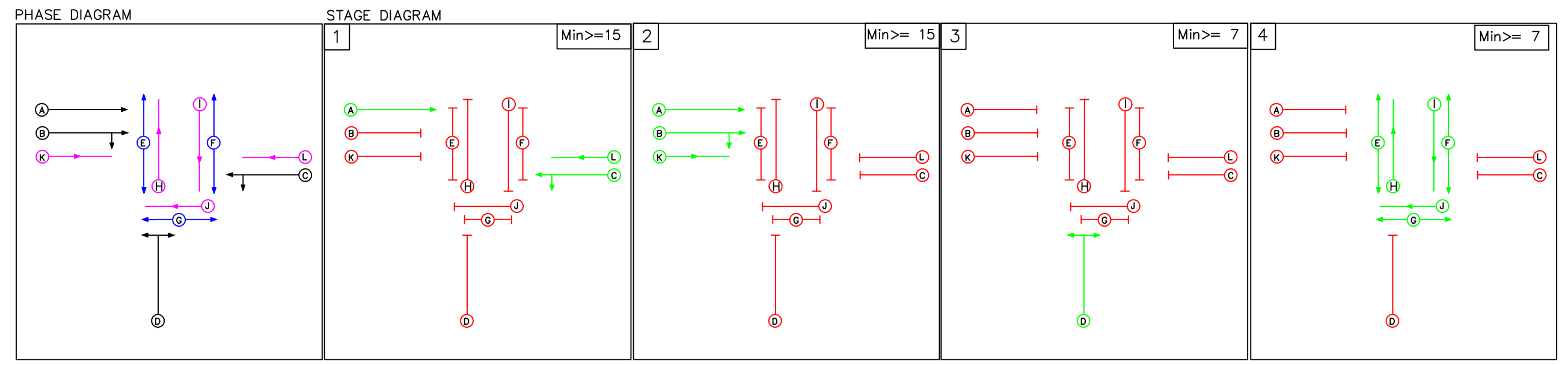

| POLE NUMBER | POLE TYPE | LENGTH | DISTANCE TO KERB | PHASE | NOTES |
|-------------|-----------|--------|------------------|---------|--|
| 1 | STUB | 2 | 800 | J | |
| 2 | STRAIGHT | 4 | 800 | G, J | |
| 3 | STRAIGHT | 4 | 800 | D, G | |
| 4 | STUB | 2 | 800 | H | |
| 5 | STRAIGHT | 2 | 800 | E, H | |
| 6 | OLE | - | - | B, C, K | Tram optic to be incorporated into RAG as an upside-down T shape |
| 7 | STRAIGHT | 4 | 800 | A, E | |
| 8 | STRAIGHT | 4 | 800 | A, B, D | |
| 9 | STUB | 2 | 800 | F, I | |
| 10 | OLE | - | - | F, I | |
| 11 | STRAIGHT | 4 | 800 | C, L | Tram optics to be incorporated into RAGs as 4-inlines REINFORCING STEEL MESH AT FOUNDATION |
| 12 | STRAIGHT | 4 | 800 | C, F | |

| DETECTOR NUMBER | DETECTOR NAME | DEMAND PHASE | EXTEND PHASE | DETECTOR TYPE | NOTES |
|-----------------|---------------|--------------|--------------|---------------|---------|
| 1 | AMD | A | A | MICROWAVE | POLE 7 |
| 2 | CMD | C | C | MICROWAVE | POLE 12 |
| 3 | DMD | D | D | MICROWAVE | POLE 3 |
| 4 | ASLD | A | A | MICROWAVE | POLE 7 |
| 5 | BSLD | B | B | MICROWAVE | POLE 6 |
| 6 | DSLD | D | D | MICROWAVE | POLE 3 |
| 7 | PB1 | J | J | PUSH BUTTON | POLE 1 |
| 8 | PB2 | G | G | PUSH BUTTON | POLE 2 |
| 9 | PB3 | G | G | PUSH BUTTON | POLE 3 |
| 10 | PB4 | H | H | PUSH BUTTON | POLE 4 |
| 11 | PB5 | E | E | PUSH BUTTON | POLE 5 |
| 12 | PB6 | E | E | PUSH BUTTON | POLE 7 |
| 13 | PB7 | I | I | PUSH BUTTON | POLE 9 |
| 14 | PB8 | F | F | PUSH BUTTON | POLE 10 |
| 15 | PB9 | F | F | PUSH BUTTON | POLE 12 |